

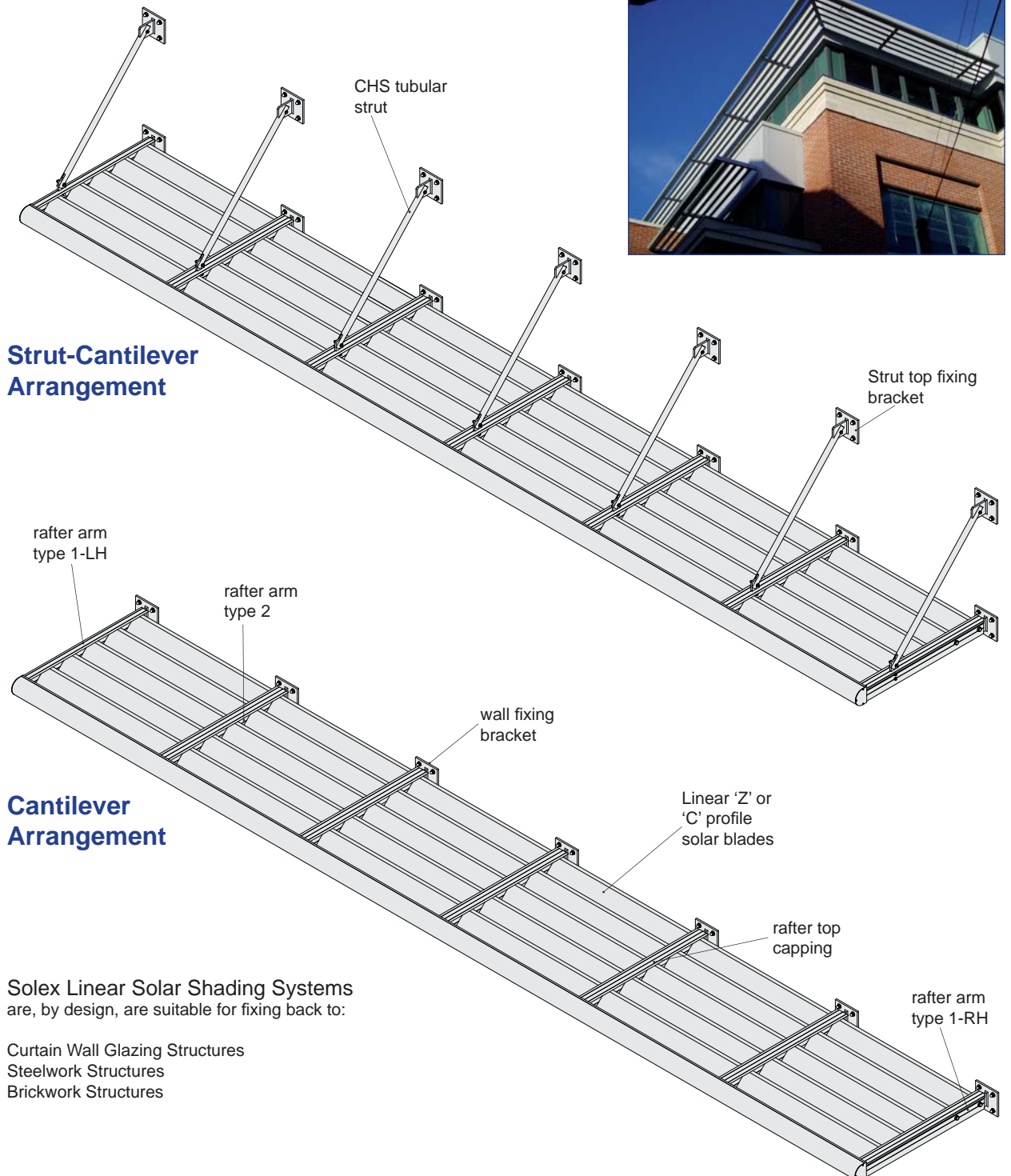

Solex Linear External Solar Shading System



Solex Linear Solar Shading Systems are, by design, suitable for fixing back to:

- Curtain Wall Glazing Structures
- Steelwork Structures
- Brickwork Structures

Solinear Limited

Unit 9 Brunel Park Industrial Estate, Blyth Road, Harworth, Doncaster. DN11 8NE
Tel: 01302 759700 Fax: 01302 759711 email: mail@solinear.co.uk



Solex Linear External Solar Shading System

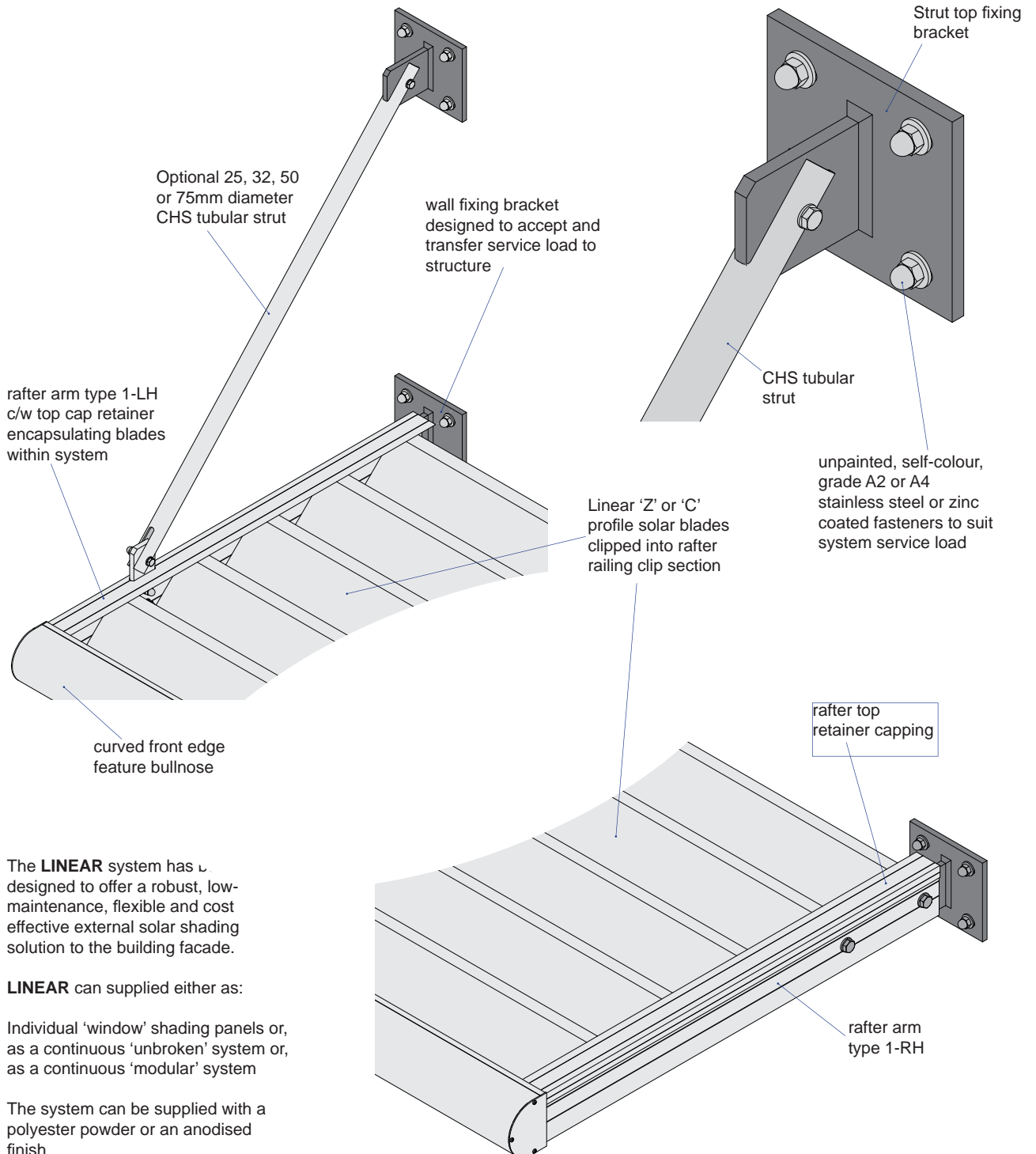

Solinear Limited

Unit 9 Brunel Park Industrial Estate, Blyth Road, Harworth, Doncaster. DN11 8NE
 Tel: 01302 759700 Fax: 01302 759711 email: mail@solinear.co.uk



Solex Linear Solar Shading System Typical Details into Glazing

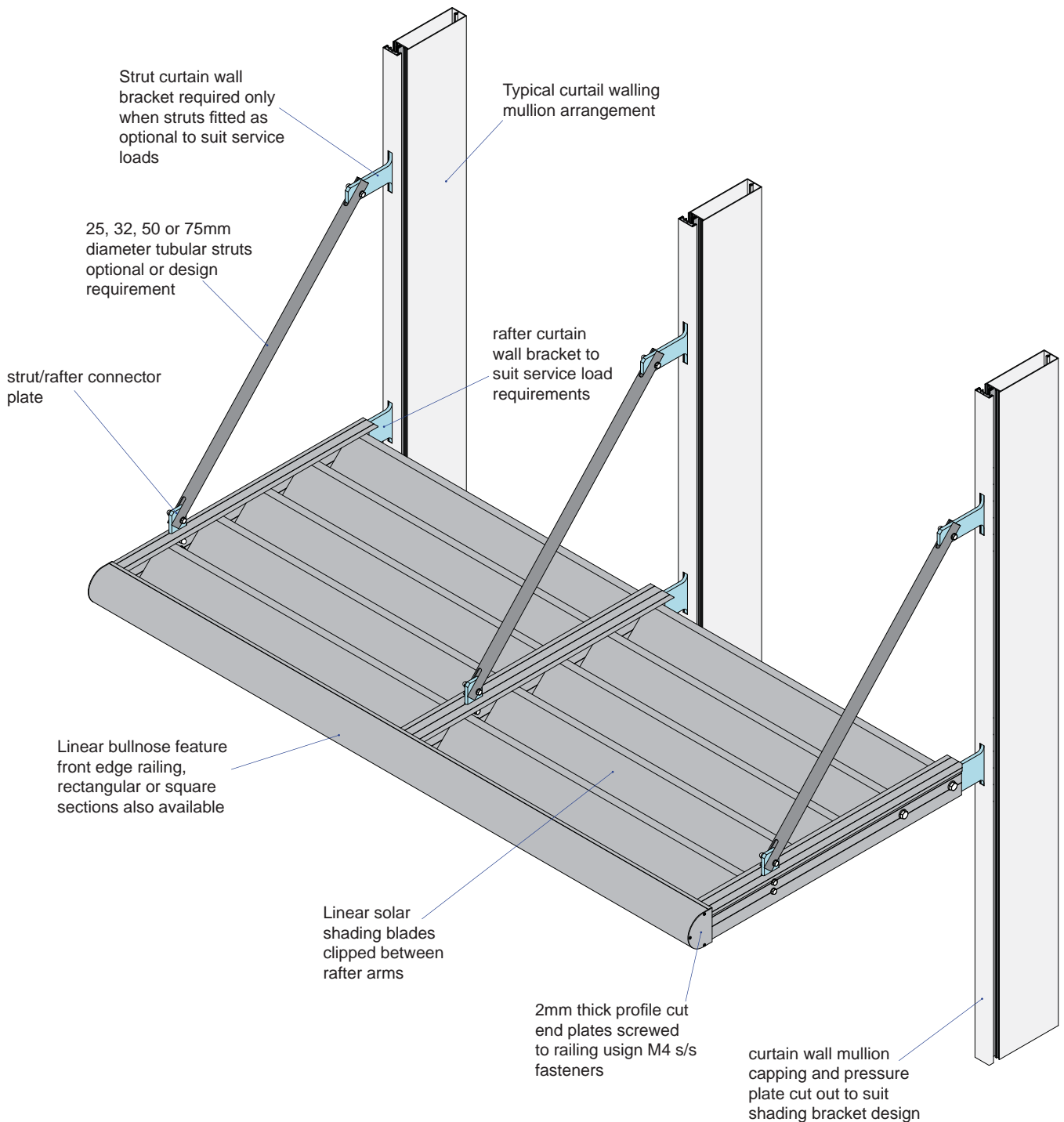

Solinear Limited

Unit 9 Brunel Park Industrial Estate, Blyth Road, Harworth, Doncaster. DN11 8NE
Tel: 01302 759700 Fax: 01302 759711 email: mail@solinear.co.uk



Solex Linear Solar Shading System Typical Details into Glazing

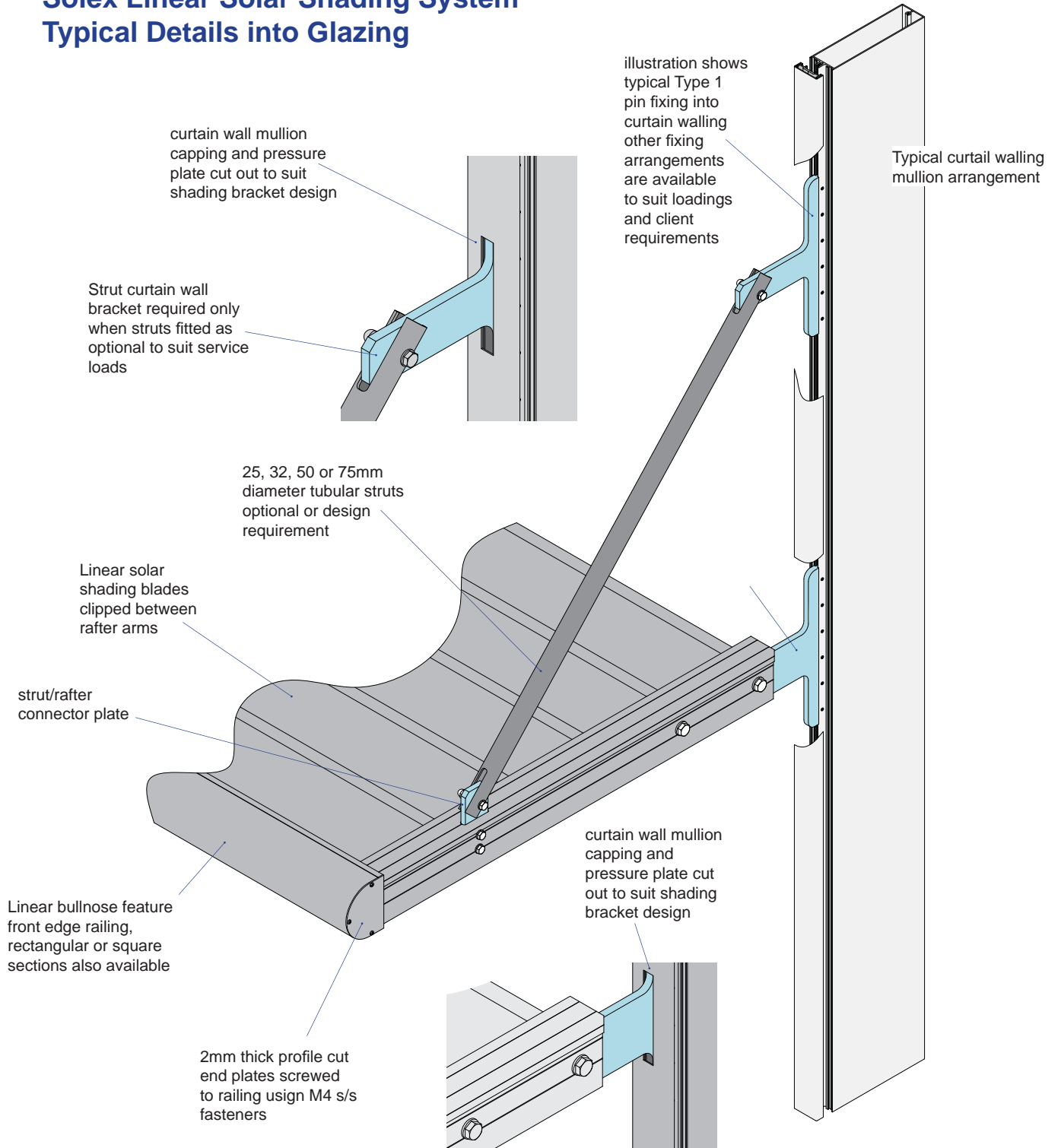

Solinear Limited

Unit 9 Brunel Park Industrial Estate, Blyth Road, Harworth, Doncaster. DN11 8NE
Tel: 01302 759700 Fax: 01302 759711 email: mail@solinear.co.uk



Solex Linear External Solar Shading System - Typical Details (not to scale)

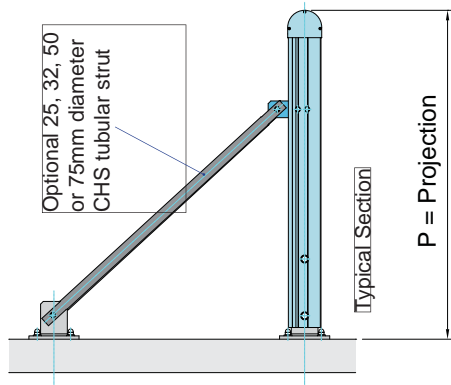

Standard LINEAR System Horizontal Projections:

- Solex Linear-01 - P = nom 825mm - 4 shading blades
- Solex Linear-02 - P = nom 985mm - 5 shading blades
- Solex Linear-03 - P = nom 1150mm - 6 shading blades
- Solex Linear-04 - P = nom 1325mm - 7 shading blades
- Solex Linear-05 - P = nom 1500mm - 8 shading blades

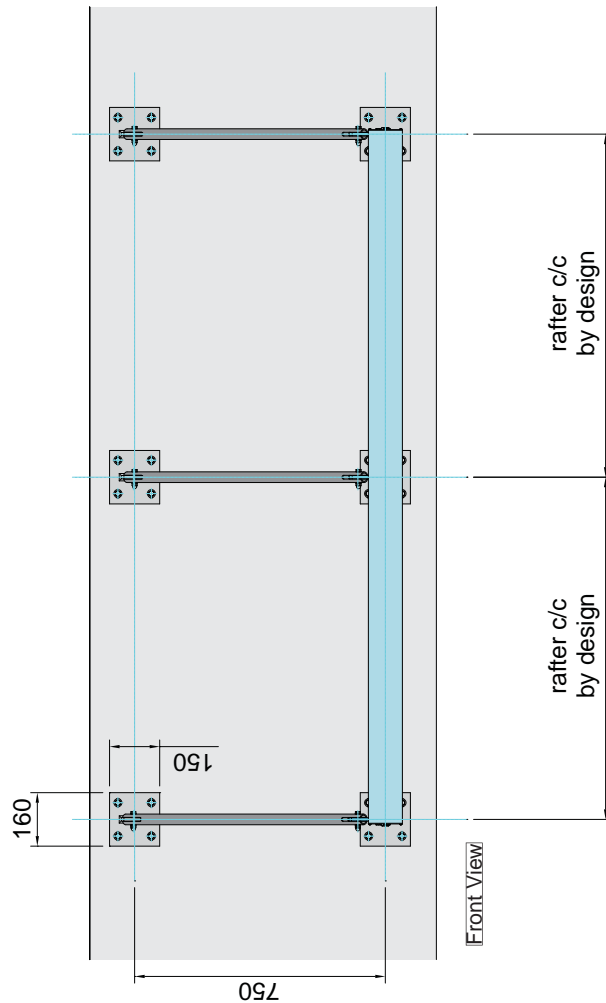
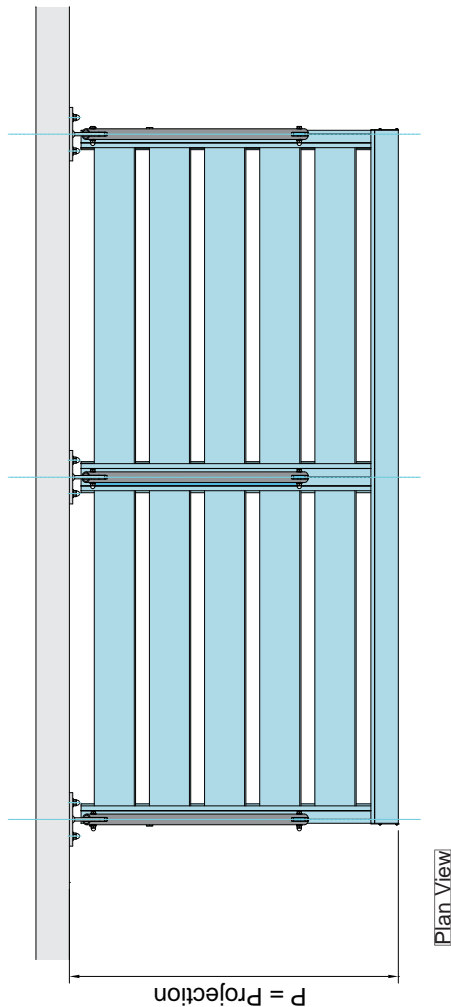

Solinear Limited

Unit 9 Brunel Park Industrial Estate, Blyth Road, Harworth, Doncaster. DN11 8NE
 Tel: 01302 759700 Fax: 01302 759711 email: mail@solinear.co.uk



Solex Linear-04 Solar Shading System Typical Section c/w Optional Strut - Not to Scale

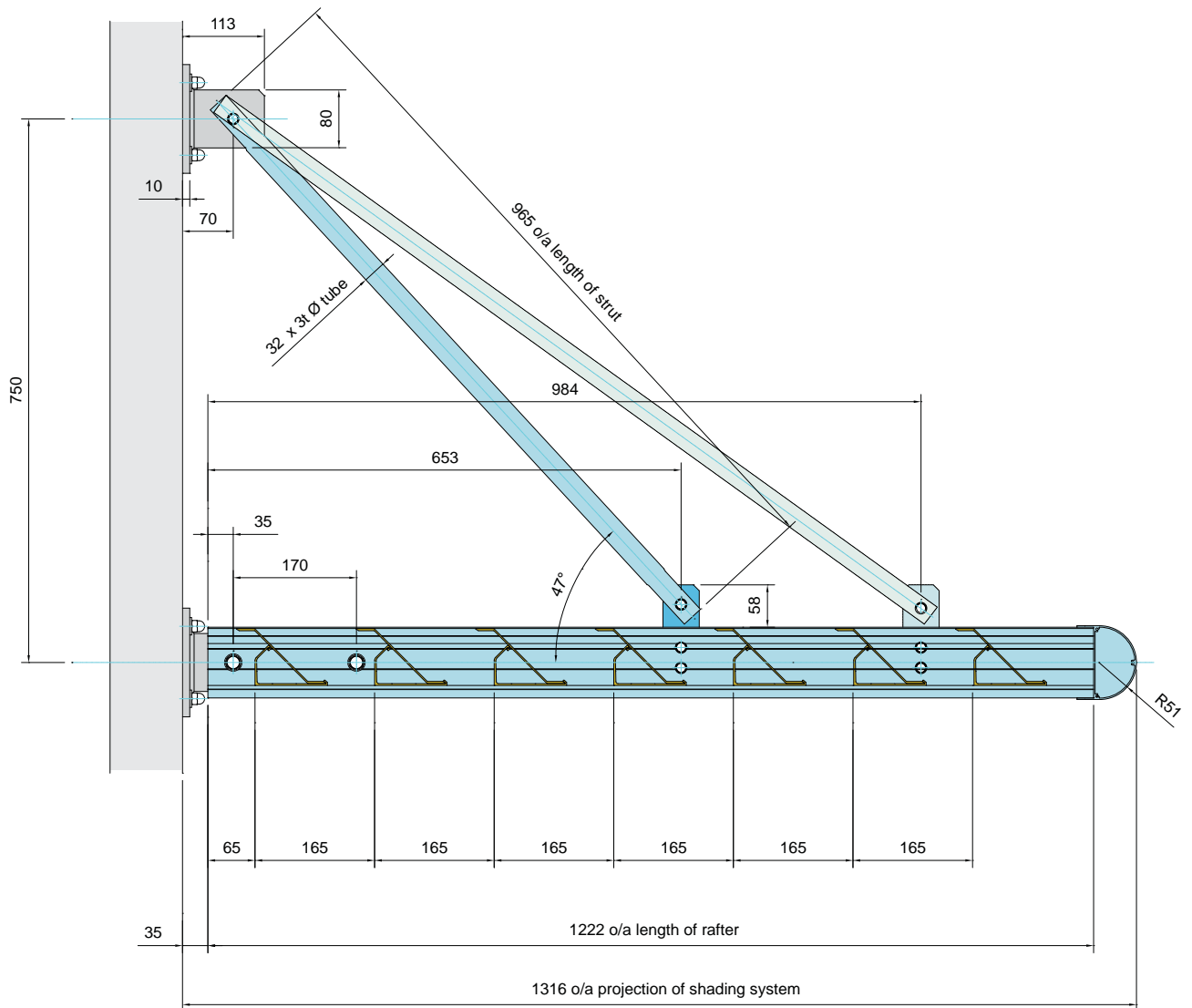

Solinear Limited

Unit 9 Brunel Park Industrial Estate, Blyth Road, Harworth, Doncaster. DN11 8NE
Tel: 01302 759700 Fax: 01302 759711 email: mail@solinear.co.uk



Solex Linear-04 Solar Shading System Typical Section c/w Optional Strut - Not to Scale

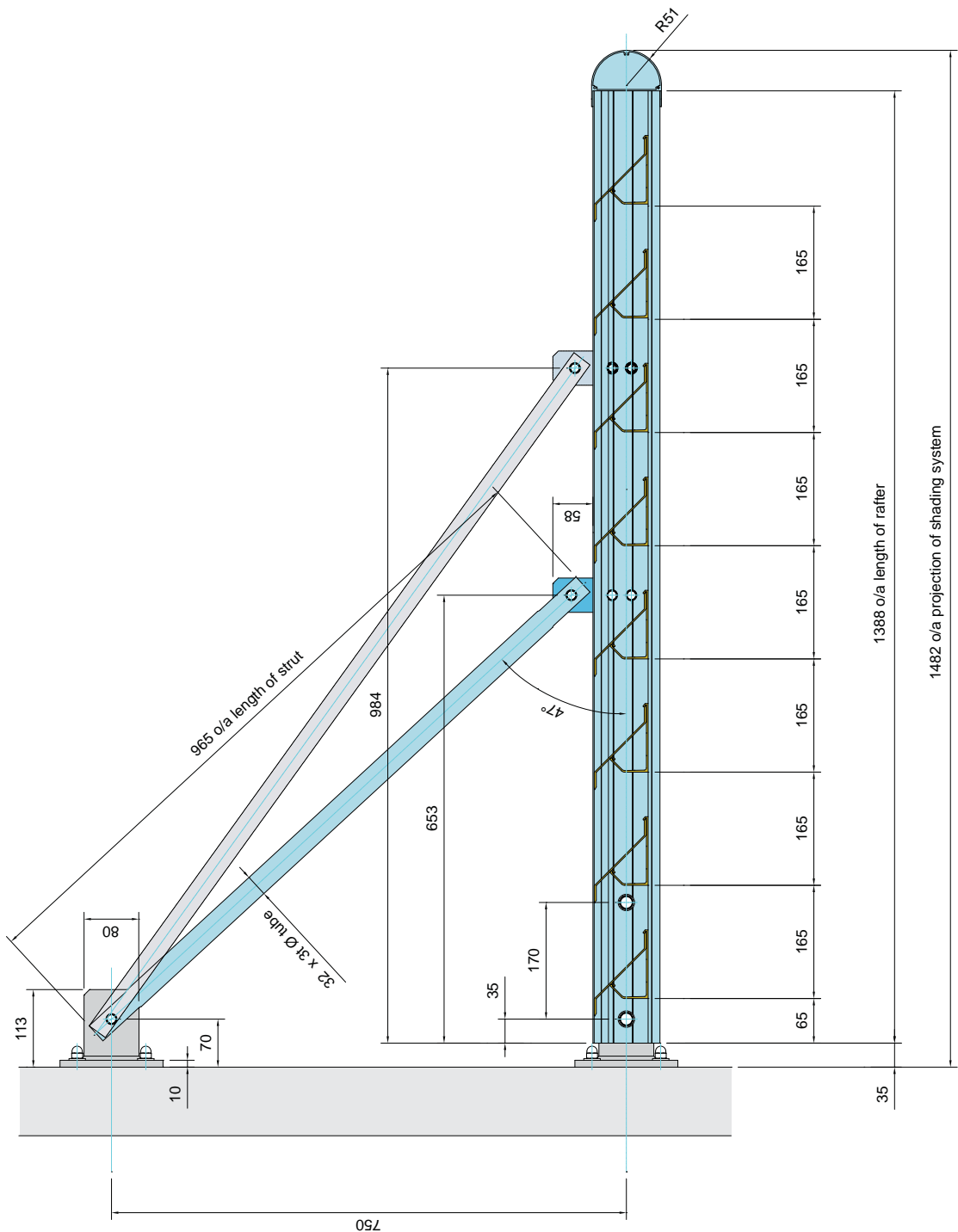

Solinear Limited

Unit 9 Brunel Park Industrial Estate, Blyth Road, Harworth, Doncaster. DN11 8NE
Tel: 01302 759700 Fax: 01302 759711 email: mail@solinear.co.uk